

Fletcher & Company

151 Station Road, Mickleover, Derby, DE3 9FL

Price Guide £315,000

Freehold



- A Well Proportioned Traditional Semi Detached House
- Envious Location In Sought After Mickleover
- Entrance Hall And Lounge/Dining Room
- Comprehensively Fitted Kitchen
- Three Bedrooms
- Modern Shower Room
- Parking For Several Cars
- Extensive, Enclosed Rear Garden And Patio
- Planning Approval For Erection Of An Outbuilding/Annexe
- Easy Access To Derby City Centre, A6, A38 and A50





Summary

A traditional semi detached house located in the popular Derby suburb of Mickleover and extremely well placed for all local amenities such as shops, schools, eateries and easy connection to the city centre, A6, A38 and A50.

The well presented accommodation includes an entrance hall, lounge/dining room, a comprehensively fitted kitchen, three bedrooms and a modern shower room.

The house enjoys an enviable plot with off road parking for several cars and an extensive rear garden which is enclosed.

Planning permission has been granted for the erection of an Annexe/outbuilding/home office.

An internal inspection is recommended to appreciate this lovely family home.

F&C

The Location

The property's location is within easy reach of the centre of Mickleover with an excellent range of amenities including a large supermarket, a varied selection of shops and facilities, restaurants, bars, a regular bus service into Derby City centre, good schooling at both primary and secondary levels and close to pleasant open countryside with interesting walks. Also extremely well placed for easy access to the A38, A50 and A6.

Accommodation

On The Ground Floor

Entrance Hall

16'3" x 6'3" (4.97 x 1.93)

Having a UPVC double glazed entrance door with feature leaded glass insert above, a UPVC double glazed leaded glass window to side, tile flooring, dado rail and central heating radiator. There is an understairs cupboard which provides excellent storage space and stairs lead off to the first floor.



Lounge/Dining Room

30'8" x 10'9" (9.36 x 3.28)

Having an LVT wood grain effect floor, a UPVC double glazed bay window with leaded glass insert to the front and double glazed French doors provide access to the rear garden. Two central heating radiators.



Kitchen

15'6" x 7'3" (4.73 x 2.23)

Comprehensively fitted with a range of cream, high gloss modern base cupboards, drawers and eye level units with a complementary roll top work surface over incorporating a stainless steel sink drainer unit with mixer tap. Having space for a range cooker, stainless steel splashback, stainless steel extractor hood with light and an integrated dishwasher. There is an integrated fridge and freezer. Having tiling to the floor, two UPVC double glazed window to the side elevations and a UPVC double glazed door provides access to the rear garden.



On The First Floor

Landing

8'1" x 4'7" (2.47 x 1.41)

Having a dado rail, a UPVC double glazed leaded glass window to the side elevation and providing access to the roof space, which has a pull down ladder.

Bedroom One

15'6" x 10'8" (4.73 x 3.27)

Having a UPVC double glazed leaded glass window with stained glass insert to the front elevation and a central heating radiator.



Bedroom Two

15'1" x 9'10" (4.60 x 3.00)

Having a central heating radiator and a UPVC double glazed bay window overlooking the rear garden.



Bedroom Three

8'9" x 6'3" (2.67 x 1.93)

With a central heating radiator and a UPVC double glazed window with leaded and stained glass insert to the front elevation.



Shower Room

7'9" x 7'4" (2.37 x 2.24)

Appointed with a three piece modern white suite comprising a walk-in shower cubicle with mains fed shower over, a wall mounted wash handbasin, low flush WC, with full modern tiling to the walls and wood grain effect quality vinyl floor. There is a chrome heated towel rail, inset spotlighting to the ceiling, extractor fan with light and a UPVC double glazed window with frosted glass to the rear. Having a wall mounted bathroom cabinet with mirrored front and a built-in cupboard which provides excellent storage space.



Outside

To the front of the property the house is nicely set back from the road behind a block paved driveway which provides off-road parking for several vehicles. There is a flower bed to the front with hedges to either side. A gate to the side provides access to the rear and there is a detached garage.

To the rear there is a paved patio with an extensive lawned garden beyond with an additional patio at the far end. A wooden garden shed provides excellent storage.



Planning For Erection Of An Outbuilding/Annexe

Please note that permission has been granted for the erection of an outbuilding/annexe to replace the garage
Please see the link below:

<https://eplanning.derby.gov.uk/online-applications/applicationDetails.do?activeTab=summary&keyVal=S56OYPFSHF600>

Council Tax Band E

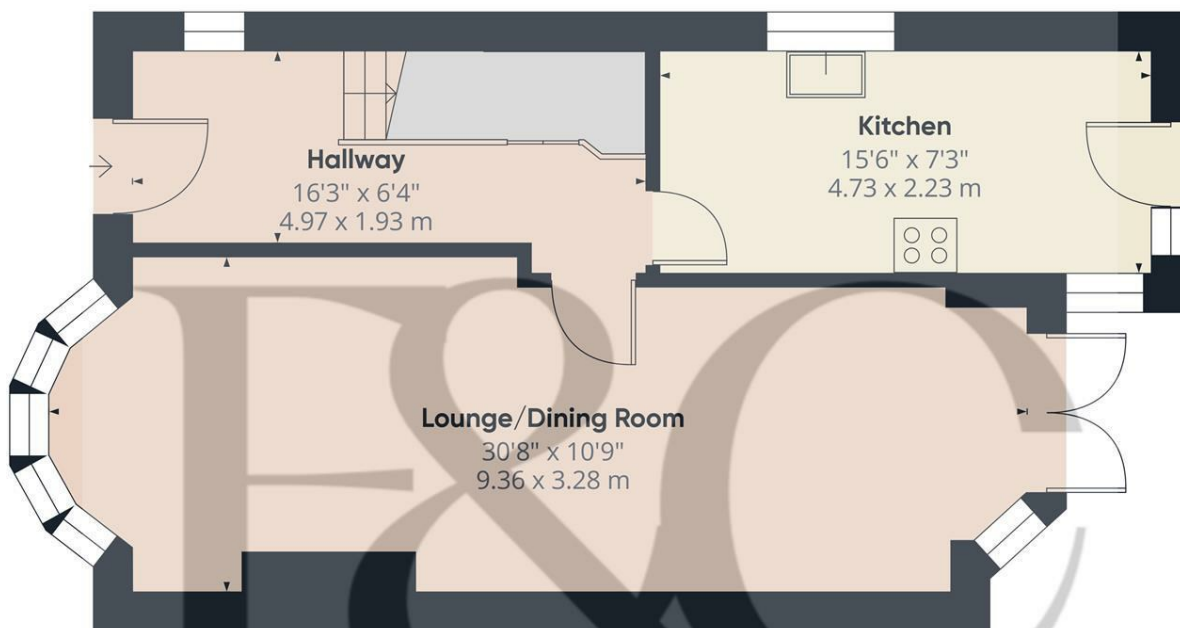

Floor 0

Approximate total area⁽¹⁾
521.72 ft²
48.47 m²

(1) Excluding balconies and terraces.

While every attempt has been made to ensure accuracy, all measurements are approximate, not to scale. This floor plan is for illustrative purposes only.

Calculations were based on RICS IPMS 3C standard. Please note that calculations were adjusted by a third party and therefore may not comply with RICS IPMS 3C.

GIRAFFE360

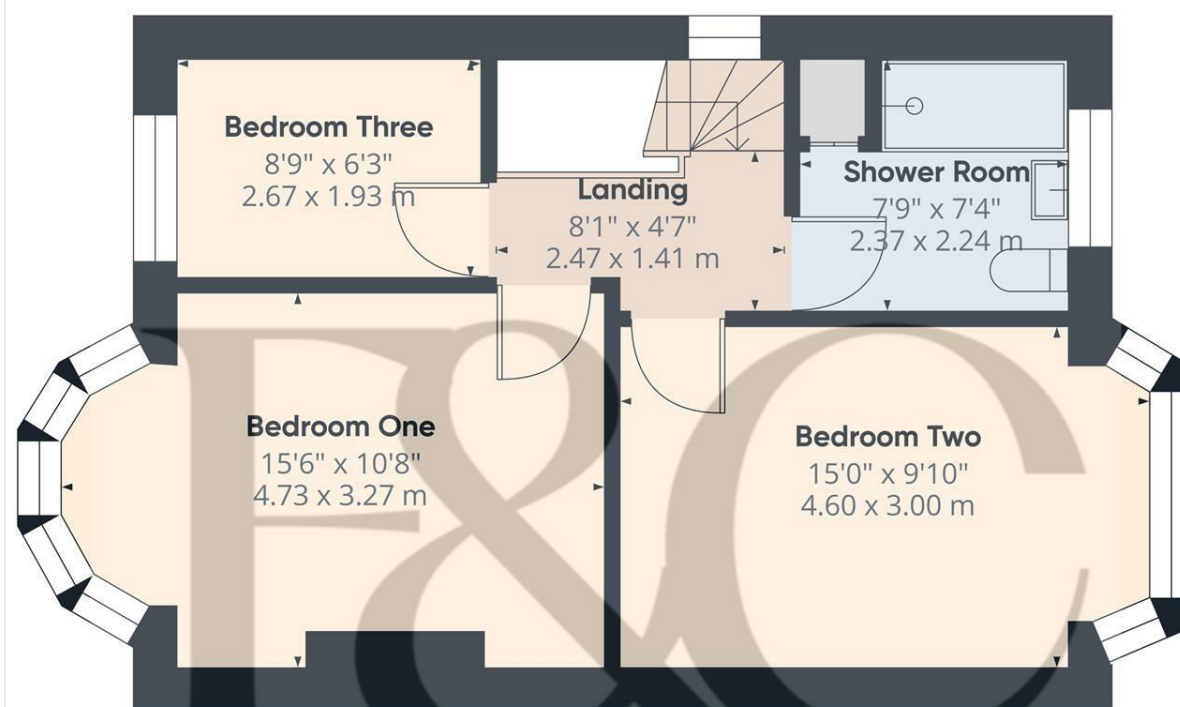

Floor 1

Approximate total area⁽¹⁾
432.49 ft²
40.18 m²

(1) Excluding balconies and terraces.

While every attempt has been made to ensure accuracy, all measurements are approximate, not to scale. This floor plan is for illustrative purposes only.

Calculations were based on RICS IPMS 3C standard. Please note that calculations were adjusted by a third party and therefore may not comply with RICS IPMS 3C.

GIRAFFE360



Energy Efficiency Rating

	Current	Potential
Very energy efficient - lower running costs		
(92 plus) A		
(81-91) B		84
(69-80) C		
(55-68) D	64	
(39-54) E		
(21-38) F		
(1-20) G		
Not energy efficient - higher running costs		
England & Wales	EU Directive 2002/91/EC	

Duffield Office

Duffield House
Town Street
Duffield
Derbyshire
DE56 4GD

01332 843390
duffield@fletcherandcompany.co.uk

Derby Office

15 Melbourne Court
Millennium Way
Pride Park
Derby
DE24 8LZ

01332 300558
derby@fletcherandcompany.co.uk

Willington Office

3 The Boardwalk
Mercia Marina
Findern Lane
Willington
Derbyshire
DE65 6DW

01283 241500
willington@fletcherandcompany.co.uk

151 Station Road
Mickleover
Derby
DE3 9FL

Council Tax Band: E
Tenure: Freehold

